



2009 Illinois Football I Decide Buddy Parking Form

Selection Deadline:
June 5, 2009

Instructions:

1. Select a 'Group Contact Person' to act as the spokesperson for the entire group.
2. List all group members below and ensure all account numbers, names, and I FUND membership levels are listed correctly.
3. Each group member should sign his/her name on the line.
4. Group members should alert the Group Contact Person of any special needs or requests.
5. The group lot choices will be determined based on the options of the **group member with the lowest priority** within the Priority Points System using the preferences listed below. Lot choices for each donor level are listed on page two of this document.
6. Please submit only **one (1)** selection form per group.

Group Contact Person: _____

Primary phone: () _____

Email address: _____

Signed: _____

Date: _____

MAIL COMPLETED FORM TO:
Athletic Ticket Office
Room 100 Assembly Hall
1800 S. First Street
Champaign, IL 61820

FAX COMPLETED FORM TO:
217/244-4170

QUESTIONS? PLEASE CALL:
217/333-3470

List Lot Preferences Here

#1 Preference	#2 Preference	#3 Preference	#4 Preference	#5 Preference
Lot _____	Lot _____	Lot _____	Lot _____	Lot _____

	Account Number	Name on Account	I FUND Club Level	Signature*
1				
2				
3				
4				
5				
6				
7				
8				
9				
10				

*By signing this form, I agree to allow the Group Contact Person to submit my preferences for parking at Memorial Stadium. I understand the Group Contact Person is the sole individual responsible for communication with the Athletic Ticket Office.



2009 Illinois Football Parking Plan

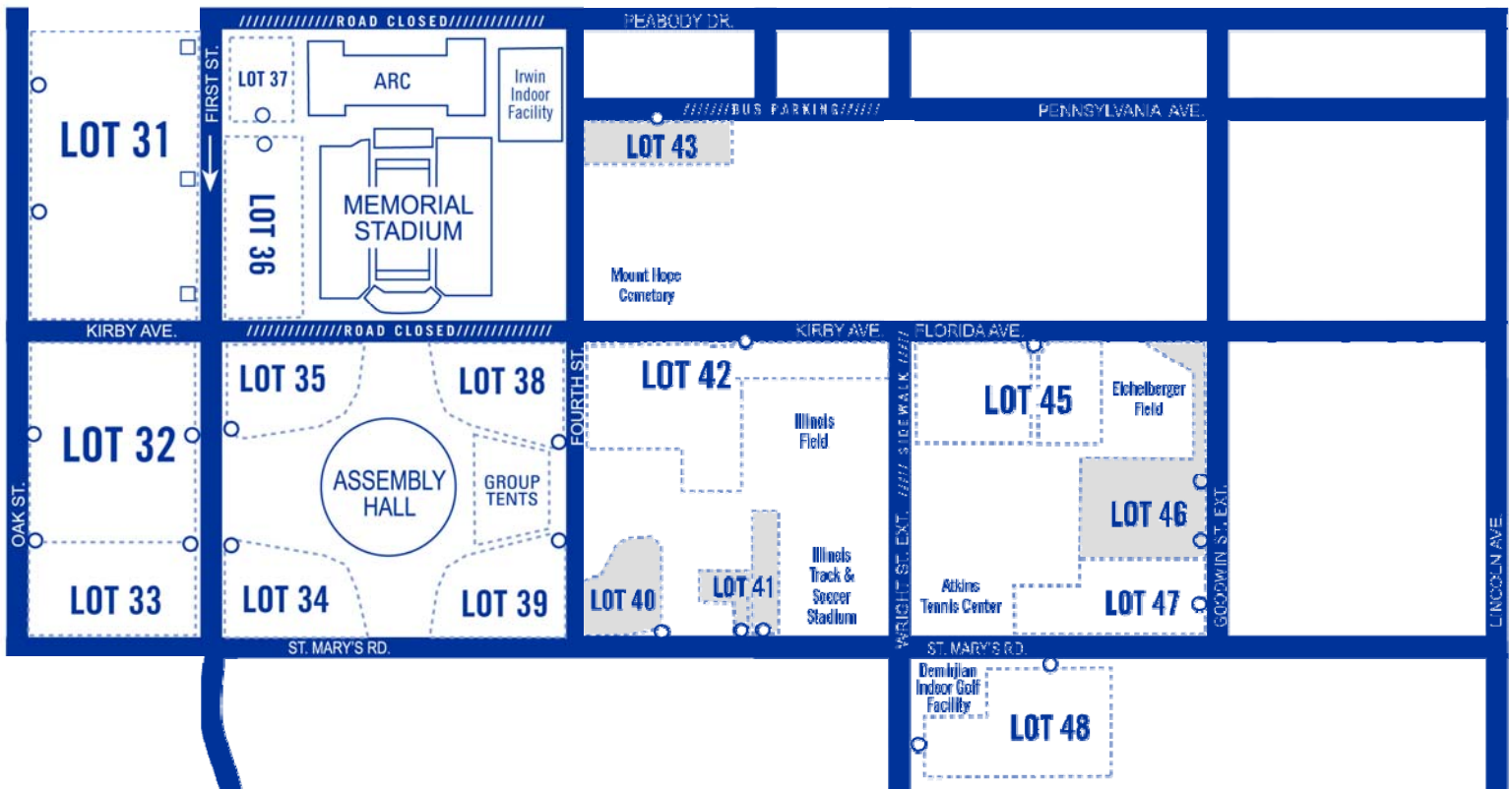

Listed below you will find the parking lot options that are available to each I FUND membership level. Remember, when selecting the preferences for your group, you must select from the options that are available to the **lowest ranking I FUND member of your group.**

Parking Priority Order (Decending)	
Level	Donation
Loyalty Circle	\$10,000 and above
Block I Council	\$6,000 to \$9,999
Olympian Club	\$3,000 to \$5,999
Oskee Club	\$1,000 to \$2,999
Champion Club	\$500 to \$999
All-American Club	\$250 to \$499
Captains Club	\$100 to \$249

<p>Loyalty Circle Options:</p> <ul style="list-style-type: none"> Lot 31 - Grass - Cars, RVs, Oversized Vehicles Lot 35 - Paved - Cars Only Personalized, reserved space Lot 36 - Grass - Cars Only Personalized, reserved space Lot 37 - Paved - Cars Only Lot 38 - Paved - Cars Only Lot 42 - Grass - Cars, RVs, Oversized Vehicles 	<p>Oskee Club Options:</p> <ul style="list-style-type: none"> Lot 31 - Grass - Cars, RVs, Oversized Vehicles Lot 32 - Paved - Cars Only Lot 35 - Paved - Cars Only Lot 38 - Paved - Cars Only Lot 39 - Paved - Cars Only Lot 42 - Grass - Cars, RVs, Oversized Vehicles
<p>Block I Council Options:</p> <ul style="list-style-type: none"> Lot 31 - Grass - Cars, RVs, Oversized Vehicles Lot 35 - Paved - Cars Only Lot 37 - Paved - Cars Only Lot 38 - Paved - Cars Only Lot 42 - Grass - Cars, RVs, Oversized Vehicles 	<p>Champion Club Options:</p> <ul style="list-style-type: none"> Lot 32 - Paved - Cars Only Lot 38 - Paved - Cars Only Lot 39 - Paved - Cars Only Lot 42 - Grass - Cars, RVs, Oversized Vehicles Lot 45 - Grass - Cars, RVs, Oversized Vehicles
<p>Olympian Club Options:</p> <ul style="list-style-type: none"> Lot 31 - Grass - Cars, RVs, Oversized Vehicles Lot 35 - Paved - Cars Only Lot 37 - Paved - Cars Only Lot 38 - Paved - Cars Only Lot 42 - Grass - Cars, RVs, Oversized Vehicles 	<p>All-American Club Options:</p> <ul style="list-style-type: none"> Lot 32 - Paved - Cars Only Lot 39 - Paved - Cars Only Lot 42 - Grass - Cars, RVs, Oversized Vehicles Lot 45 - Grass - Cars, RVs, Oversized Vehicles Lot 47 - Grass - Cars Only Lot 48 - Grass - Cars Only
	<p>Captains Club Options:</p> <ul style="list-style-type: none"> Lot 32 - Paved - Cars Only Lot 39 - Paved - Cars Only Lot 45 - Grass - Cars, RVs, Oversized Vehicles Lot 47 - Grass - Cars Only Lot 48 - Grass - Cars Only

*Note - Passes valid only for specified lot. Parking in any other lot than the assigned lot will not be permitted.